

UPPER LEVEL PLANS SHEET NOTES

- ①1 EXISTING CANOPY AT EXIT TO REMAIN
- ①2 EXISTING SUSPENDED ACOUSTIC TILE CEILING TO REMAIN.
- ①3 LINE OF NEW PARTITION AND DOOR TO CREATE NEW VESTIBULE.
- ①4 EXISTING CARPET TO REMAIN
- ①5 EXISTING VINYL TILE TO REMAIN
- ①6 EXISTING CERAMIC TILE TO REMAIN
- ①7 EXISTING GAS METER AND SERVICE ENTRANCE

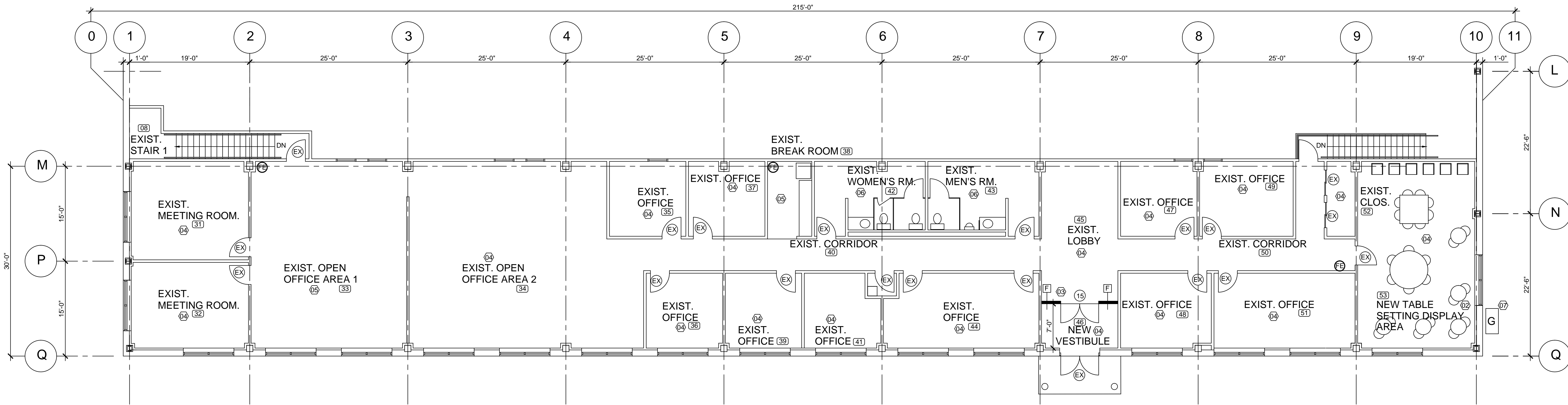

ARCHITECTURAL FLOOR PLAN/NEW WORK-UPPER LEVEL (2)
SCALE 1/8" = 1'-0"

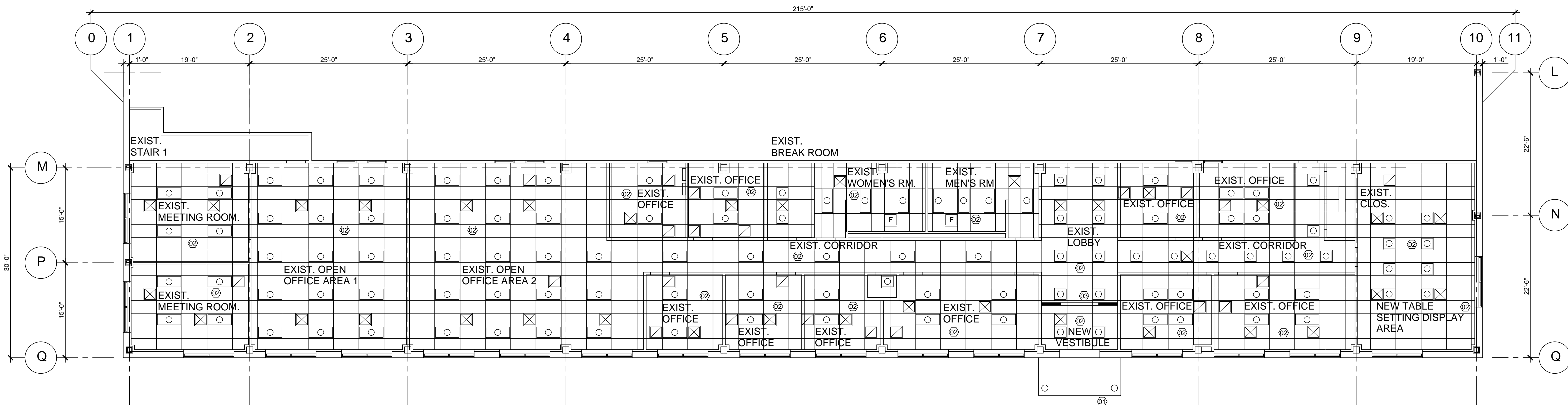

REFLECTED CEILING PLAN/NEW WORK-UPPER LEVEL (2)
SCALE 1/8" = 1'-0"

Smith Colen Architects
A Maryland General Partnership-Registration Number 9899
8428 Tea Rose Drive Gaithersburg, MD 20879 (301) 330-1023

**Potomac 18
Caterers**
8341 Beechcraft Avenue Gaithersburg, MD 20879

February 22, 2016
Robert J. Smith, AIA
I certify that these documents were prepared or approved by me, and that I am a duly licensed architect under the laws of the State of Maryland, License Number 7407-R, Expiration Date: December 18, 2016

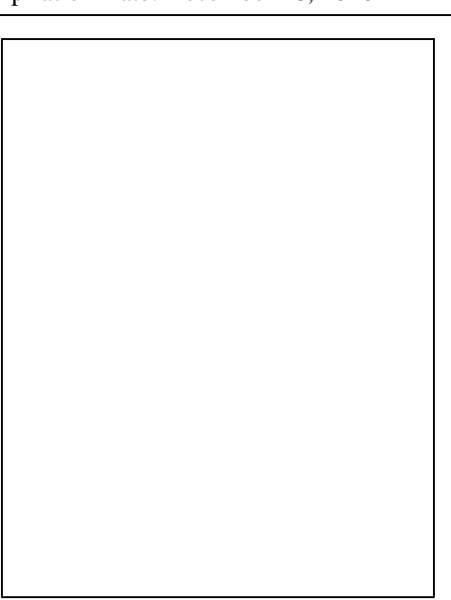

A-103