

ALL EXTERIOR WALLS ARE 2X6 @16" OC UNLESS NOTED OTHERWISE
 ALL INTERIOR WALLS ARE 2X6 @16" OC UNLESS NOTED OTHERWISE
 FOR WINDOW HEIGHTS SEE ELEVATIONS, UNLESS NOTED OTHERWISE
 FIRST FLOOR DOORS ARE 8' HIGH UNLESS NOTED OTHERWISE
 ARCHED CASE OPENINGS AT 8' HIGH UNLESS NOTED OTHERWISE
 FIRST FLOOR DOORS ARE 8' HIGH UNLESS NOTED OTHERWISE
 CABINETRY LAYOUT TO BE DETERMINED BY KITCHEN FABRICATOR (TO SUBMIT DRAWINGS)
 VERIFY DIM OF MANUFACTURED PRODUCTS WITH MFR PRIOR TO CONSTRUCTION, TYP
 5/8" GWB (TYPE "X") SHALL BE APPLIED TO THE INTERIOR SURFACES OF THE ELEVATOR SHAFT ON ALL FLOORS
 CONTACT ELEVATOR MANUFACTURER FOR DIMENSIONS AND LOCATION OF DOOR & SUPPORTS
 GUARDRAIL REQUIRED IF FLOOR OF PATIO/PORCH/DECK IS MORE THAN 30" ABOVE GRADE, TYP
 GARAGE SHALL BE SEPARATED FROM ALL LIVING SPACES WITH 1/2" GWB APPLIED TO THE GARAGE SIDE OF WALLS AND
 CEILING (5/8" TYPE "X" REQUIRED ON CEILINGS BELOW HABITABLE SPACE); THIS SHALL INCLUDE PROTECTION OF ALL
 EXPOSED BEAMS AND COLUMNS WITHIN GARAGE AREA. IRC TABLE R302.6

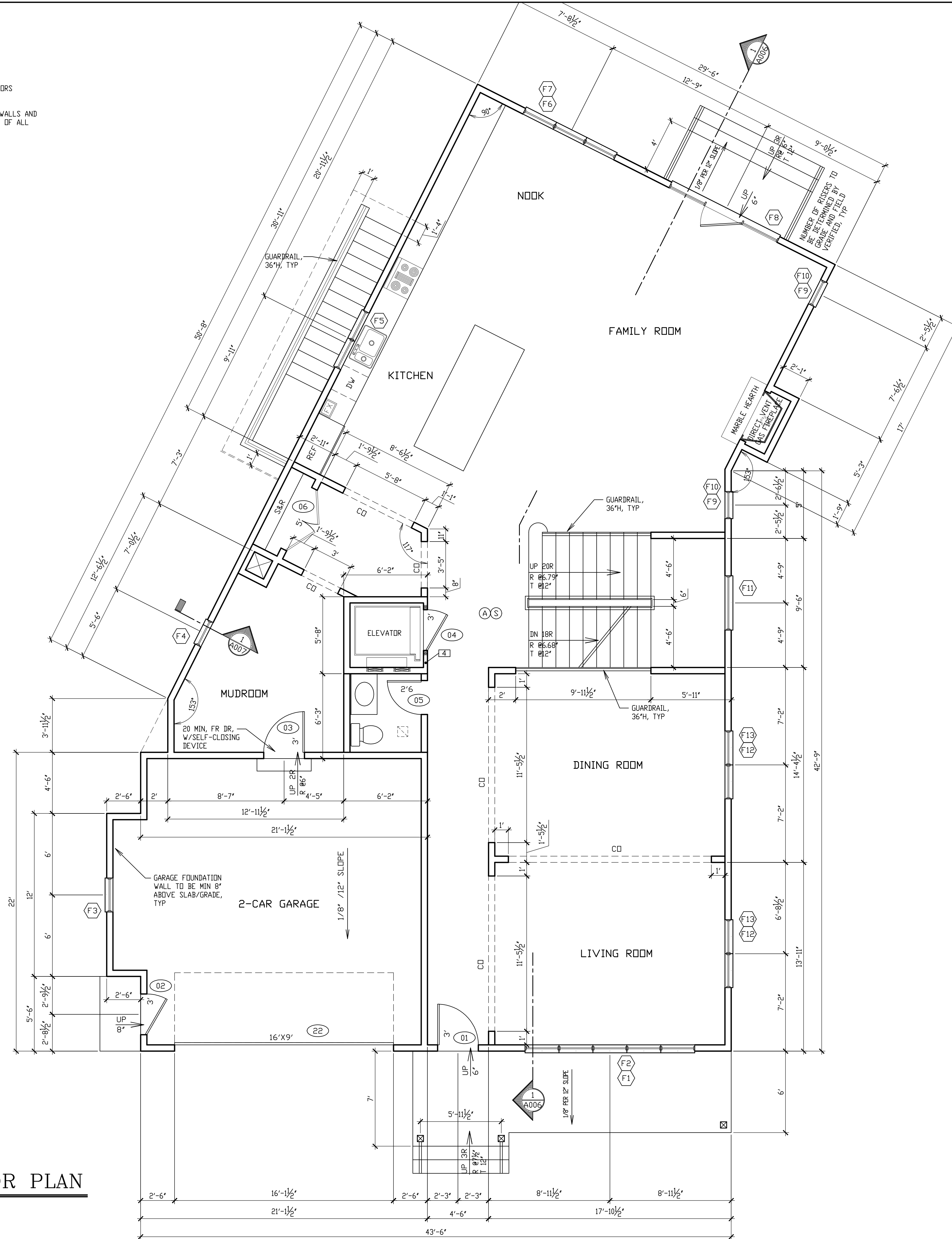

FIRST FLOOR PLAN

SCALE: 1/4" = 1'-0"

FIRST FLOOR AREA 2002 SQUARE FEET
 GARAGE AREA 476 SQUARE FEET
 FRONT PORCH AREA 154 SQUARE FEET
 REAR LANDING & STAIRS AREA 51 SQUARE FEET

DESIGN BY
BRAHMS HOMES, INC.
 DESIGN SERVICES
 24 CAS MFS, GAITHERSBURG MD 20878
 PHONE: 301-318-5454. EMAIL: brydesgn@aol.com

ARTEX BUILDERS, LLC
 ADDRESS: 1383 WOODSIDE DRIVE, McLEAN, VA 22102
 PROJECT: 3706 SPRING STREET, CHEVY CHASE, MD

CLIENT

FIRST FLOOR PLAN



I HEREBY CERTIFY THAT THESE DOCUMENTS WERE PREPARED OR APPROVED BY ME, AND THAT I AM A DULY LICENSED ARCHITECT UNDER THE LAWS OF STATE OF MARYLAND, LICENSE NUMBER 14066, EXPIRATION DATE NOV. 3, 2021.

REVISIONS:

△

COPYRIGHT © 2019 BAHRAM YOUSSEFI, ALL RIGHTS RESERVED, INCLUDING THE RIGHT OF REPRODUCTION IN WHOLE OR IN PART IN ANY FORM.

DESIGN BY: BAHRAM YOUSSEFI

SCALE: 1/4" = 1'-0"

DATE: OCTOBER 23, 2019

PROJECT NO: 19L29N07N

SHEET 3 OF 12

A001